

CARNOT Usermeeting 2023

From IFC to a comprehensive thermal finite element analysis as the basis of the next-generation BES



# Fraunhofer Italia

Who are we

# Digital and Sustainable Construction

Unser interdisziplinäres Team



**Dietmar Siegele**

Head of Unit  
Civil engineer and  
domotronician



**Cinzia Slongo**

GIS & Infrastructure  
Civil engineer



**Eliana Bortot**

Material  
Civil engineer



**Vincenzo Orlando**

Automation  
Mechatronics engineer



**Giancarlo De Marco**

BIM in Public  
Architect



**Elias Niederwieser**

Digital Twin  
Physicist



**Mariana Ataide**

Building Permit  
Architect



**Orjola Braholli**

Sustainability  
Architect



**Julius Emig**

Interoperability  
Civil engineer



**Ilaria Di Blasio**

Environment  
Environmental engineer



# Building Energy Modelling

—  
How does it work now?

# Building Energy Modelling

Actual approach

---

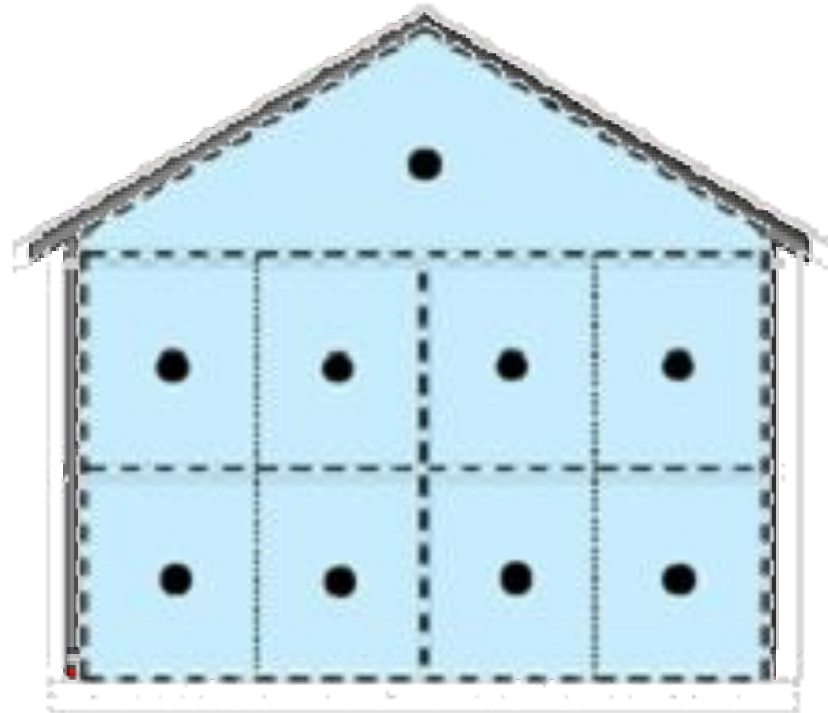

Source: Autodesk

# Building Energy Modelling

## Actual approach

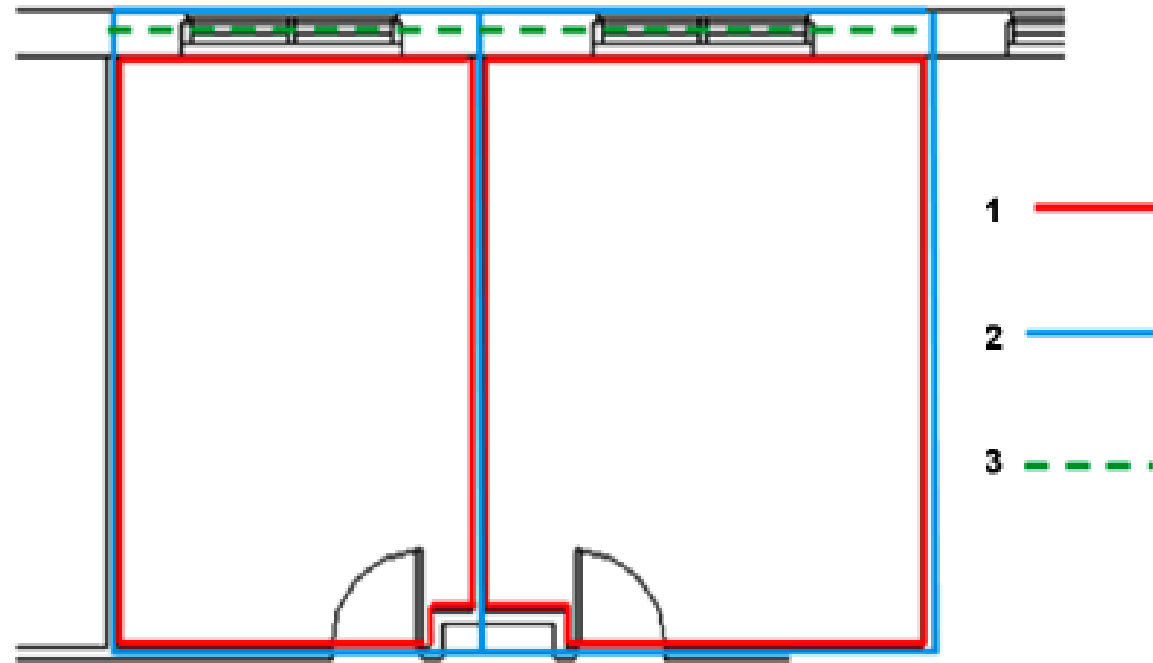

Source: Autodesk

# Building Energy Modelling

Actual approach

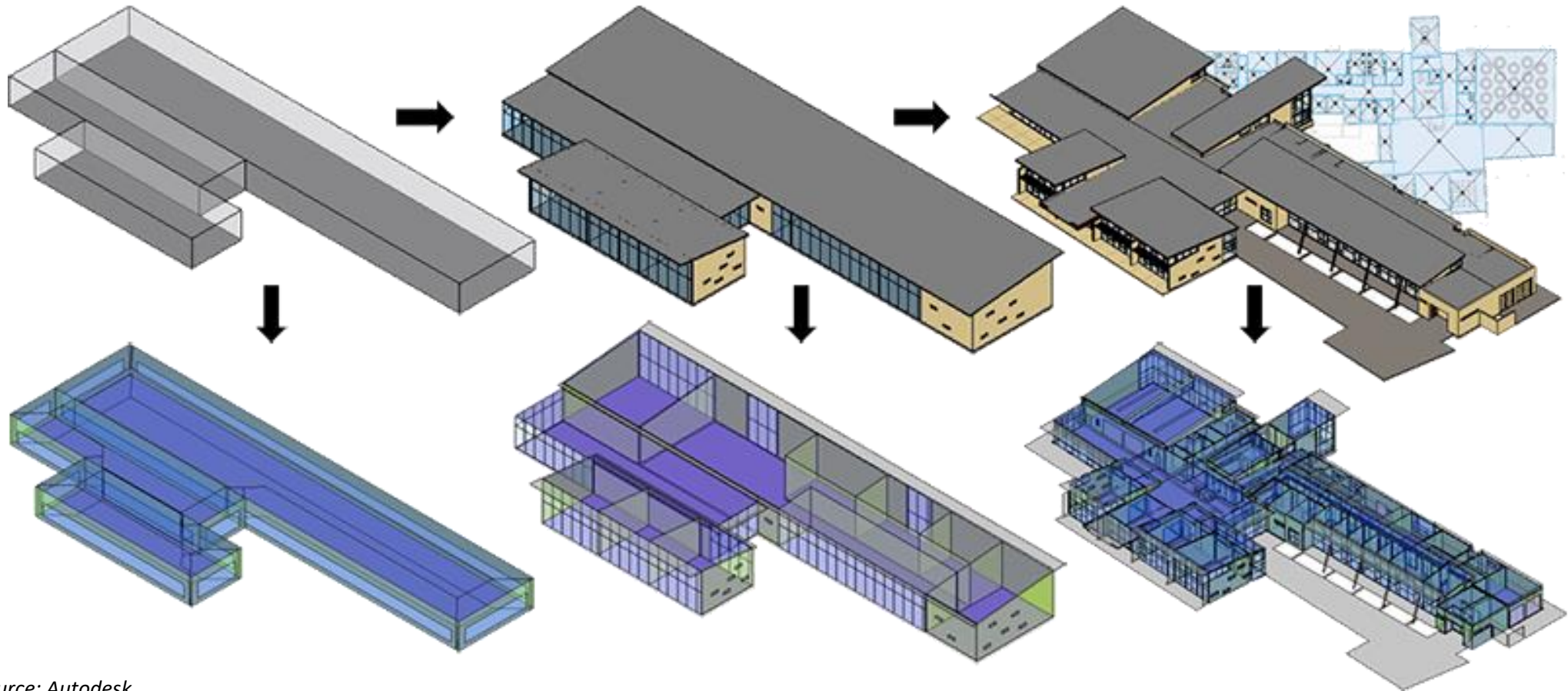

Source: Autodesk

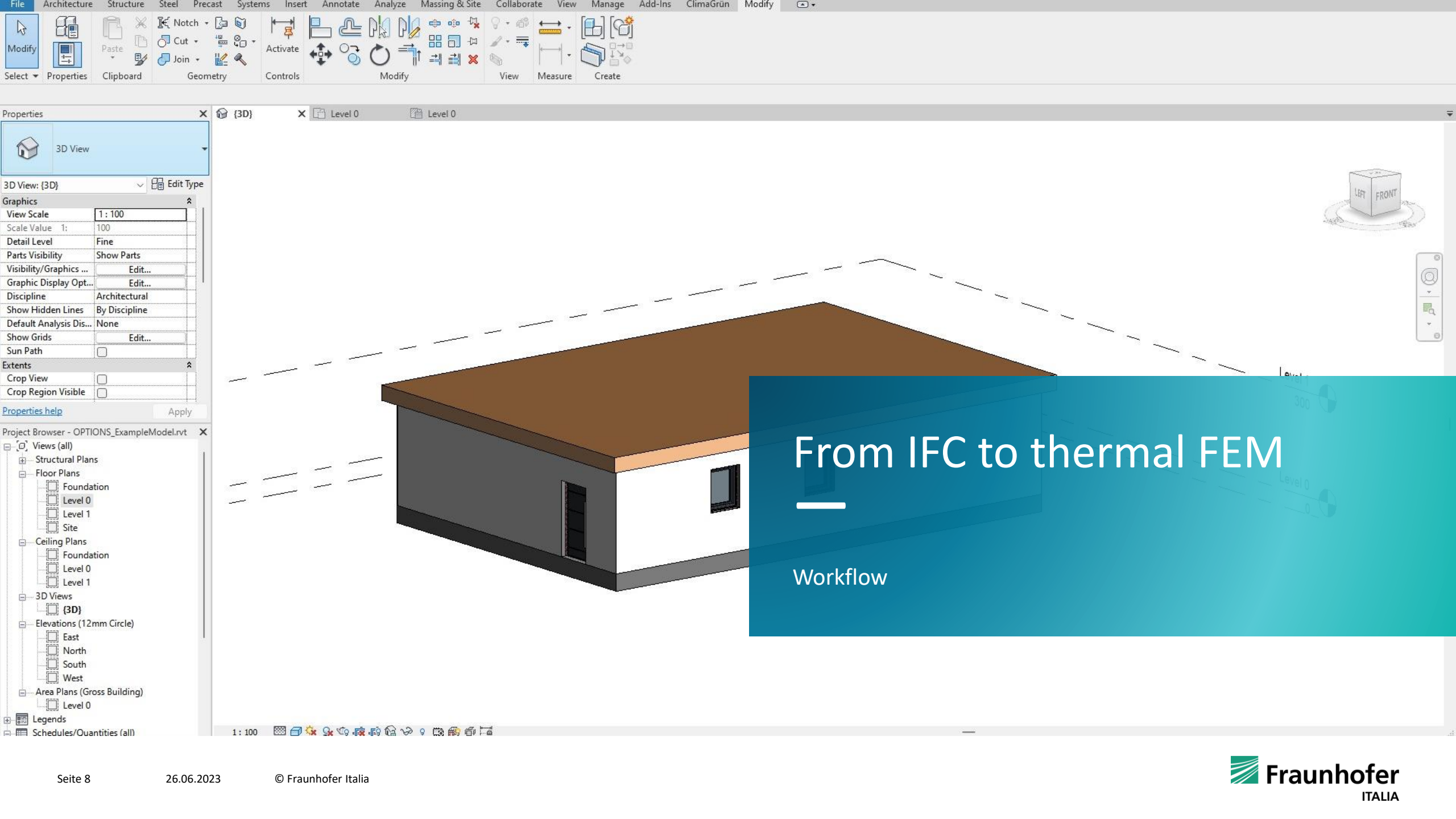

# From IFC to thermal FEM

Workflow



# From IFC to thermal FEM

## Workflow

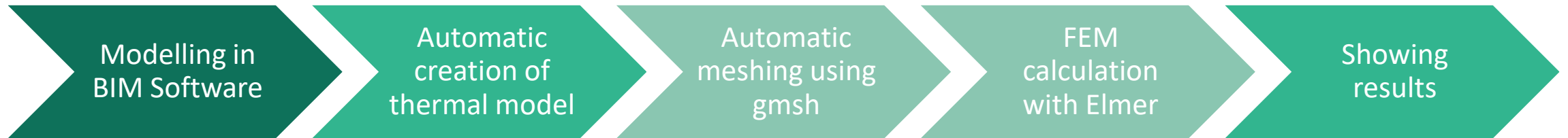

# From IFC to thermal FEM

## Workflow

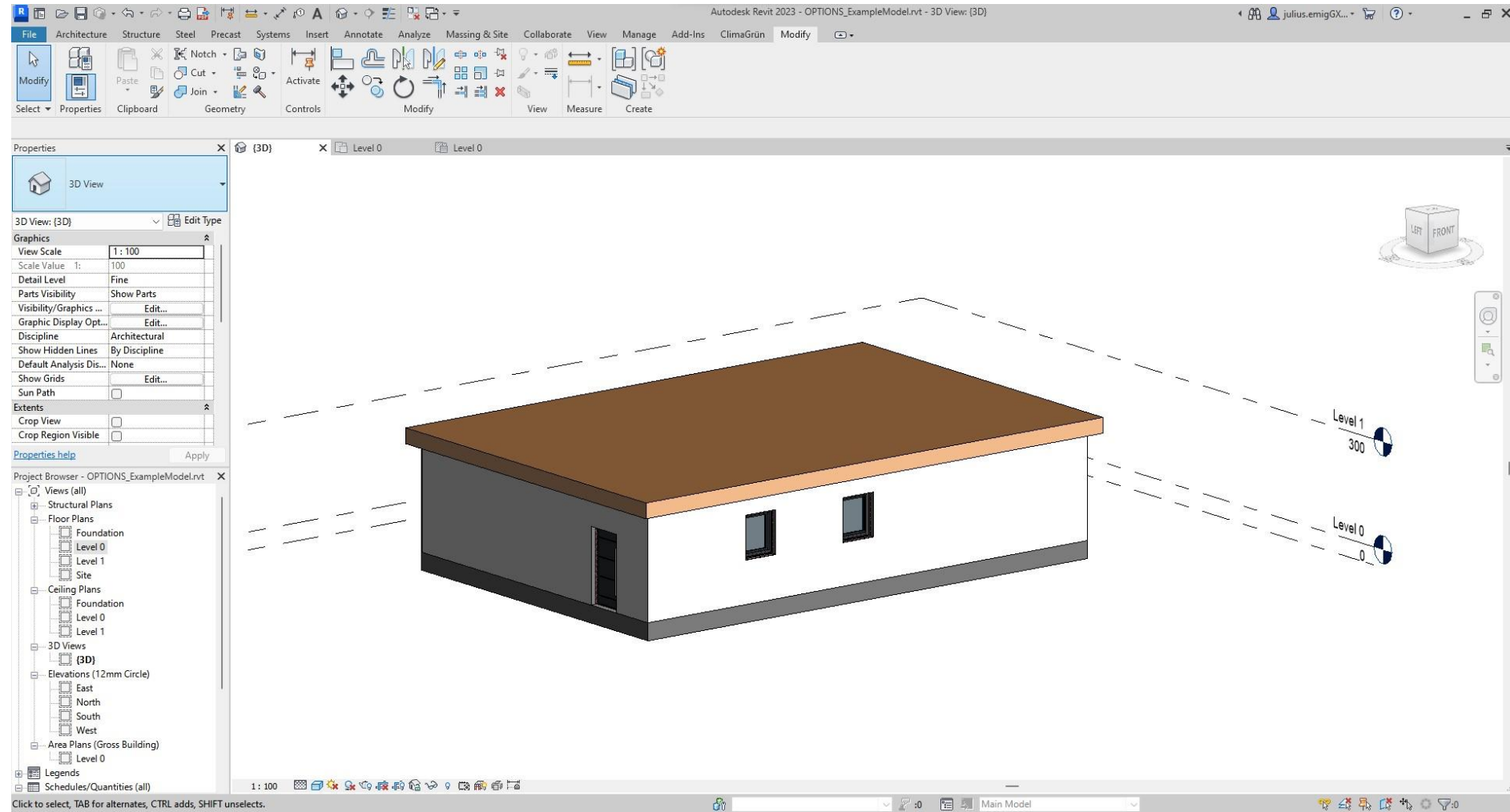

# From IFC to thermal FEM

## Workflow

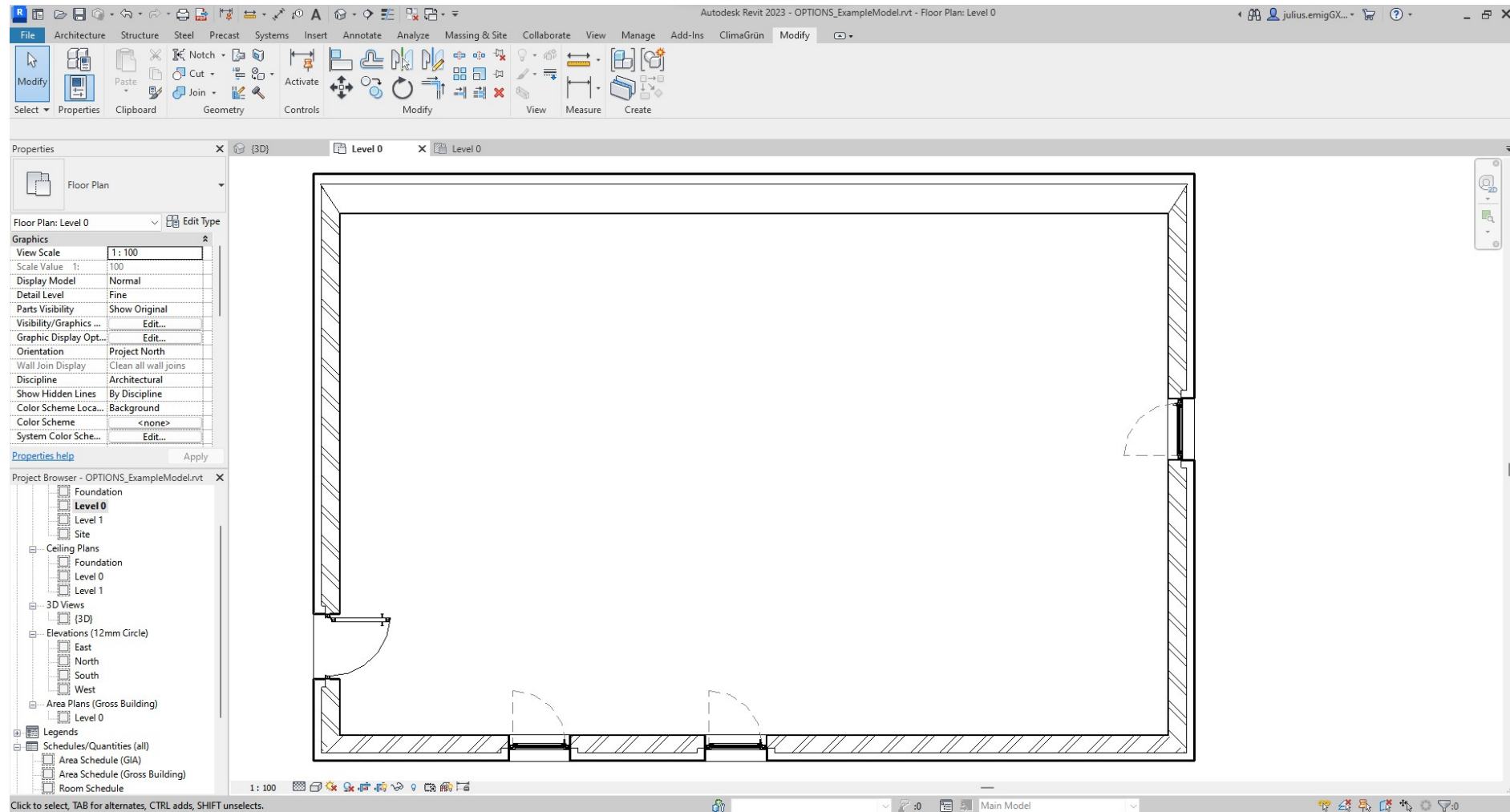

# From IFC to thermal FEM

## Workflow

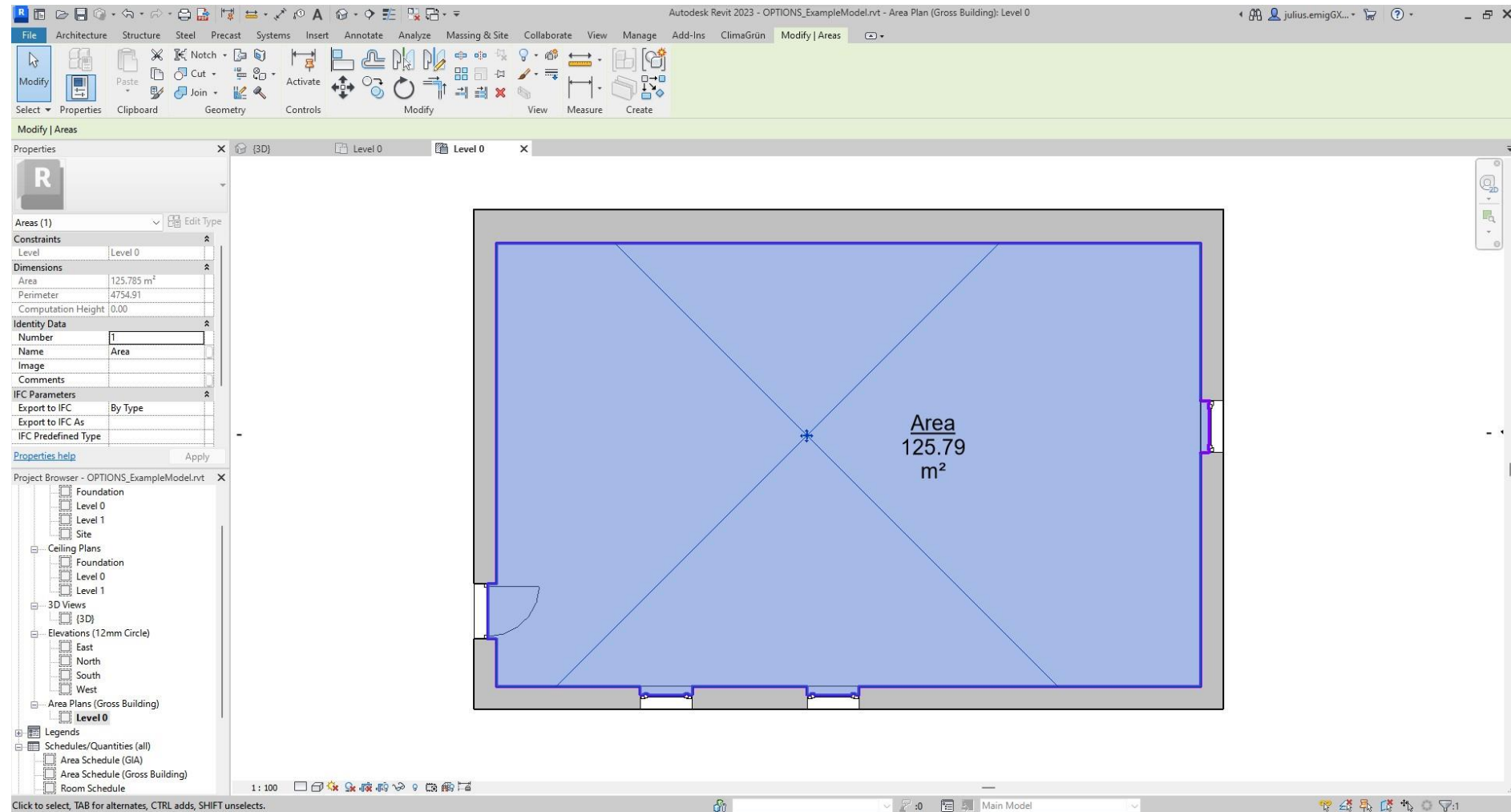

# From IFC to thermal FEM

## Workflow

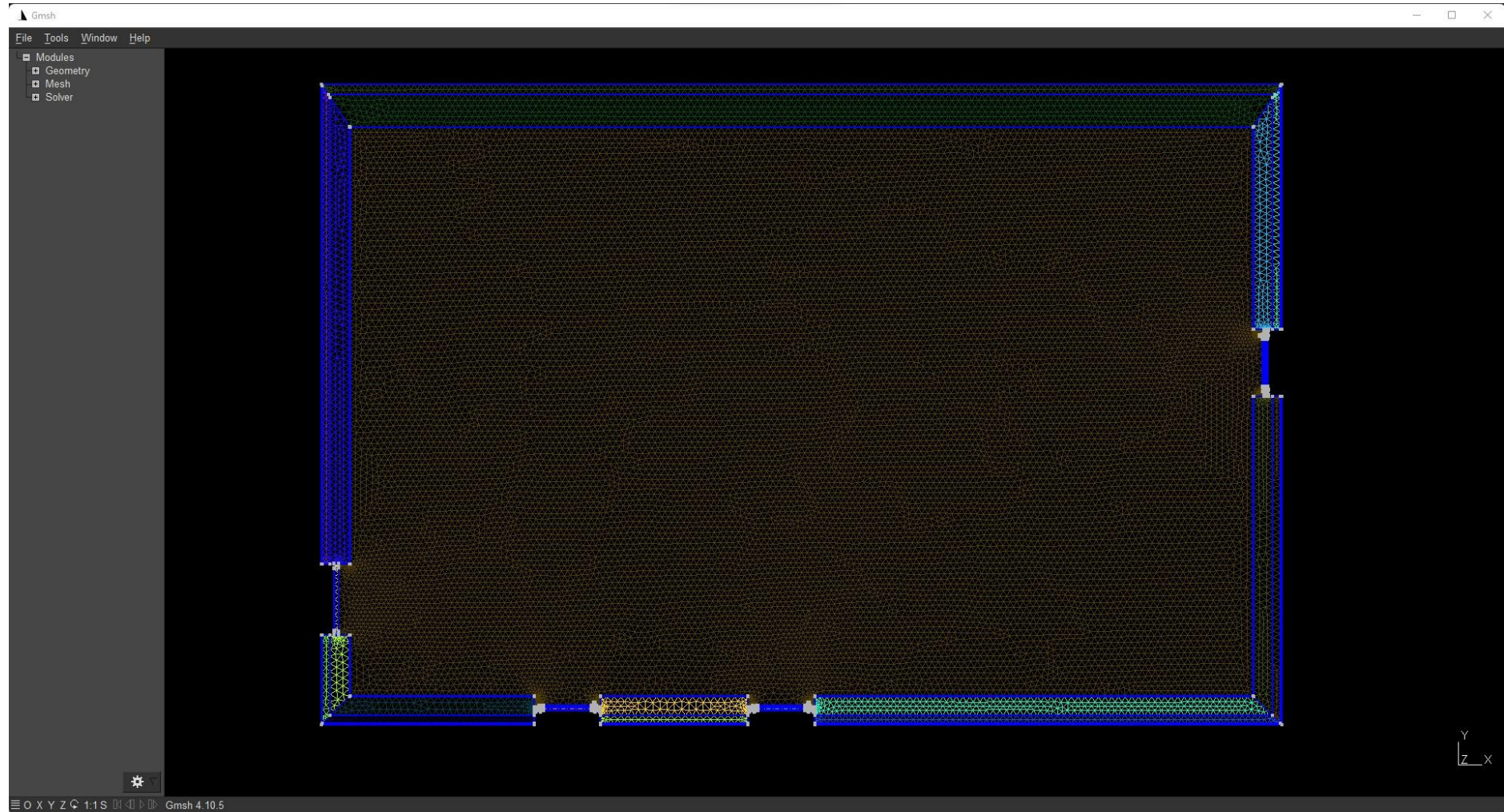

# From IFC to thermal FEM

## Workflow

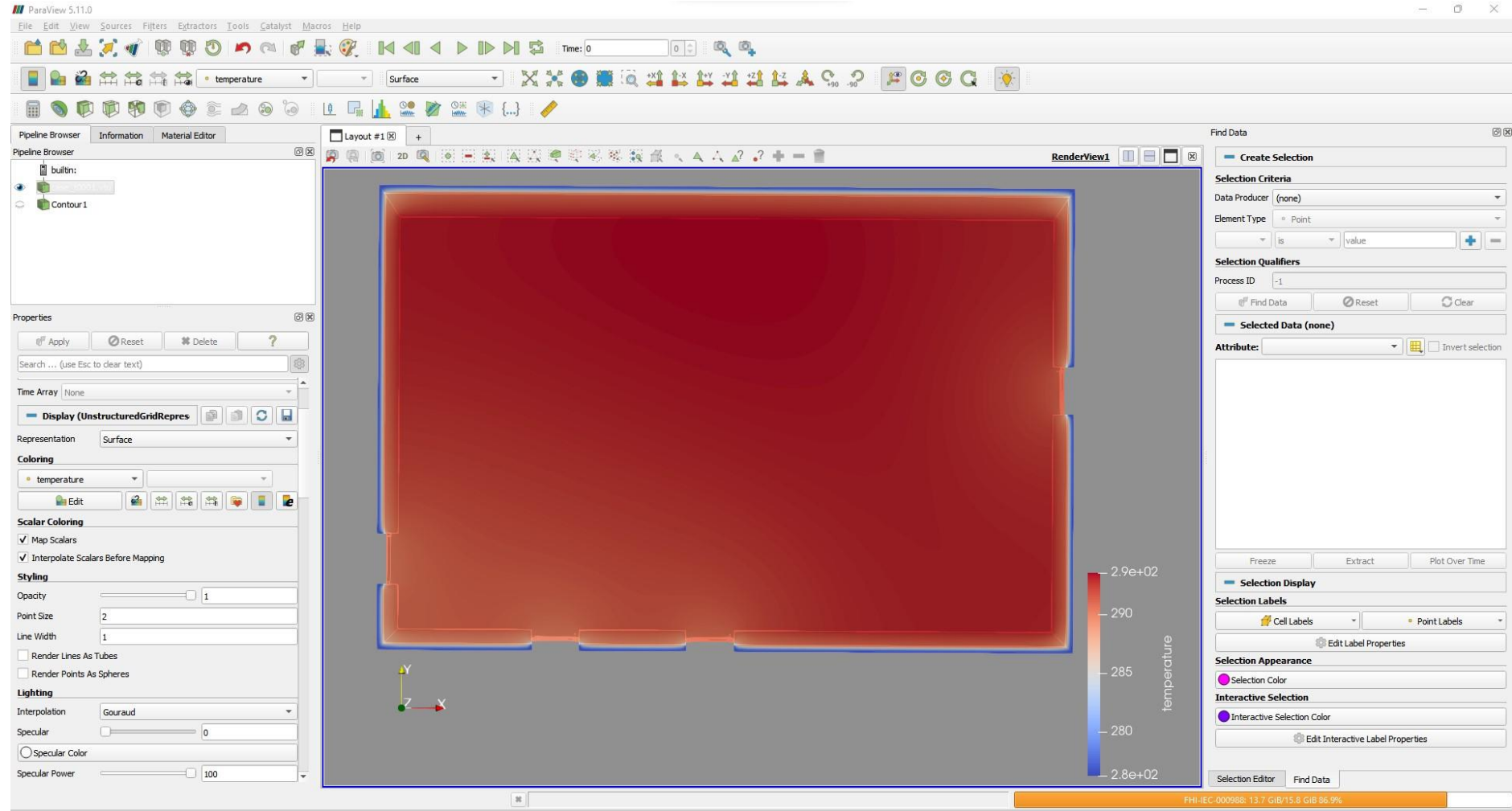

# From IFC to thermal FEM

## Workflow

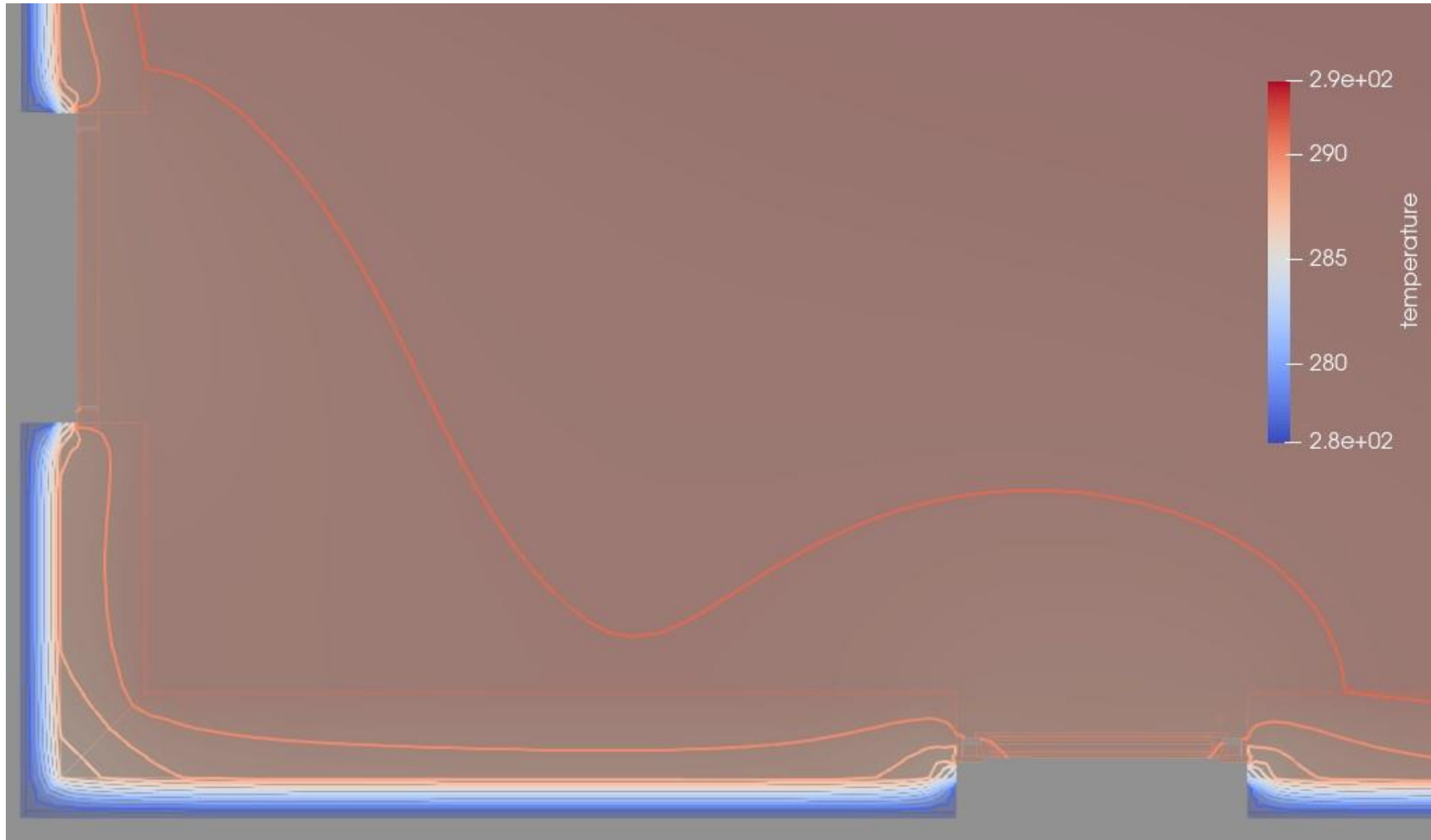

(ifc-fem-env) C:\Users\jemig\001\_Git Projects\03\_ifc\_fem\_interface\tests>



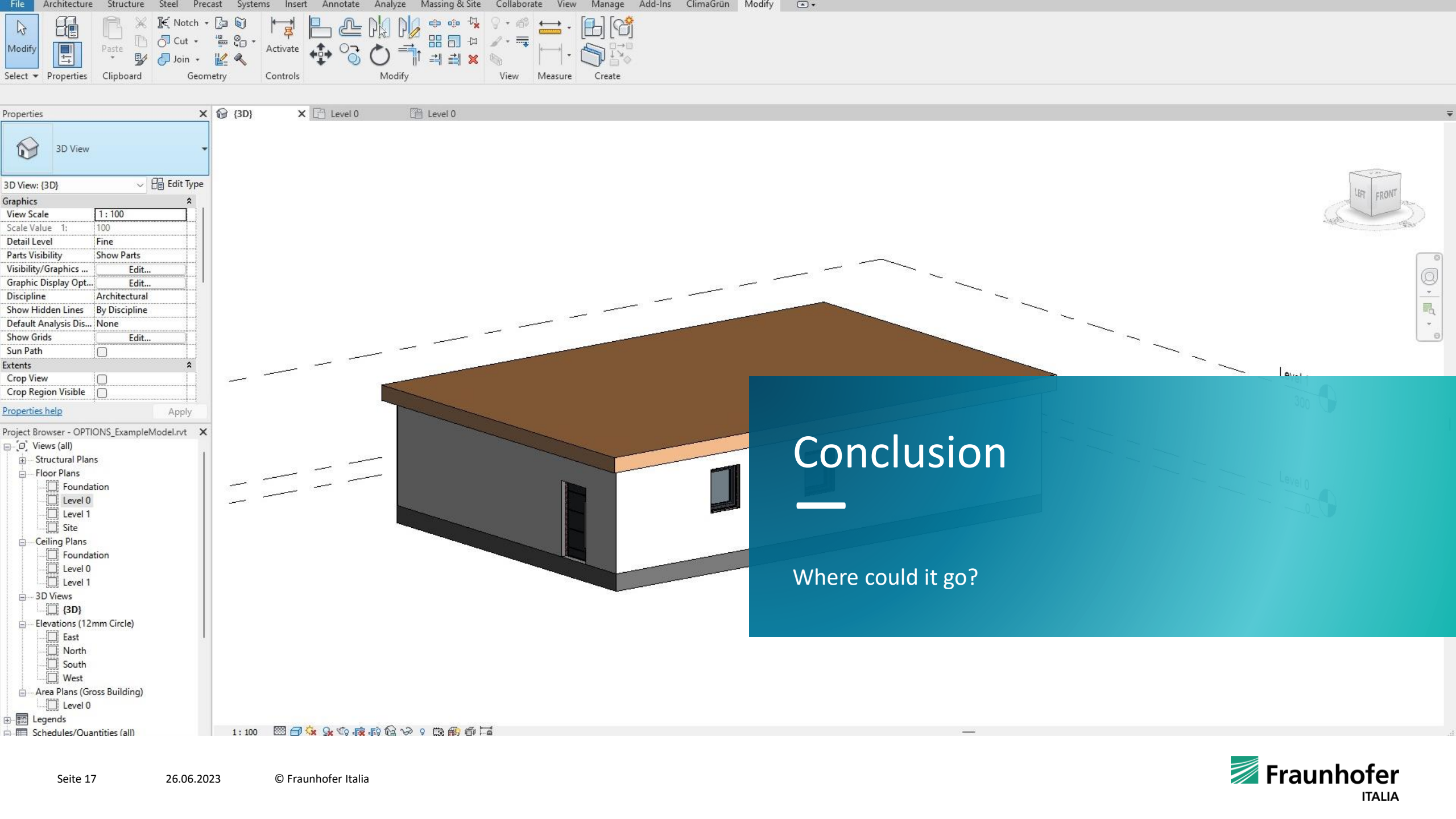

# Conclusion

Where could it go?

# Conclusion

## The future of BES?

---

- On short term:
  - Validation and parametrizing of BES models by steady state simulations or (short-time) transient simulations.
  - Complex details (thermal bridge) as transient simulation (maybe without mass).
- On long term:
  - Full transient simulations enabled by partitioning and GPU support.

# Contact

---

Dr. techn. Dietmar Siegele

Head of Unit Process Engineering in Construction

[dietmar.siegele@fraunhofer.it](mailto:dietmar.siegele@fraunhofer.it)



**Fraunhofer**  
ITALIA